

SS GEOSUB PUMP & CONTROLLER INSTRUCTIONS & MAINTENANCE

BASIC OPERATION

- Verify main power switch is in OFF position.
- Plug power cord into controller.
- Plug power cord into AC supply outlet.
- Switch main power to ON position.
- Wait for initialization sequence to complete.
- From main menu:

```
UP      START PUMP
DOWN    LOAD WELL
```

- Press  to start the pump at default settings.

- Wait for pump start up to finish.

```
PUMPING WELL #nn
PUMP START UP
```

- Press  or  to adjust pump speed to achieve desired flow rate.

```
PUMPING WELL #nn
nnn DR ON nn
```

OR

```
PUMPING WELL #nn
nnn DR OFF nn
```

- Pump water at desired pump speed

- Press  to stop pump and return to main menu.

SETTING DRY RUN

NOTE: Set point must be above 100 for Dry Run protection to be activated

- Press  to toggle Dry Run ON and OFF

NOTE: LOADING WELL #0 WILL LOAD DEFAULT START UP CONFIGURATION

FOR MAINTENANCE AND SERVICE PLEASE CALL GEOTECH DIRECTLY AT 1-800-833-7958

DIS-ASSEMBLY AND CLEANING

- Disconnect pump cable from controller.
- Unscrew outer housing (No tools needed).



- Remove inner housing by pulling apart, slightly twisting while pulling may help.
- The control module may become disconnected from the motor lead while pulling apart, this is normal.
- Remove motor assembly from inner housing by pulling apart, slightly twisting while pulling may help.
- Inspect motor assembly, impeller, and control module for damage or wear.
- Inspect internal wires for cuts or breaks, making sure all wires have insulation covering them.
- Inspect all o-rings for nicks, cuts, brittleness
- Decontaminate outer and inner housing.
- Decontaminate the motor assembly and control module.
- Decontaminate top cap and hose barb
- Clean all threads thoroughly to make sure nothing will bind them.
- Insert motor assembly back into inner housing, **be careful not to damage O-rings.**
- Connect control module wires back onto motor lead.

Note: A very small amount of inert grease or water may be used to help lubricate O-ring seals.

- Twist the motor assembly and inner housing assembly 180 degrees, coiling the wires to create more room.
- Push the inner housing over the top cap, **be careful not to damage O-rings.**

Install the outer housing **making sure the threads do not bind.**

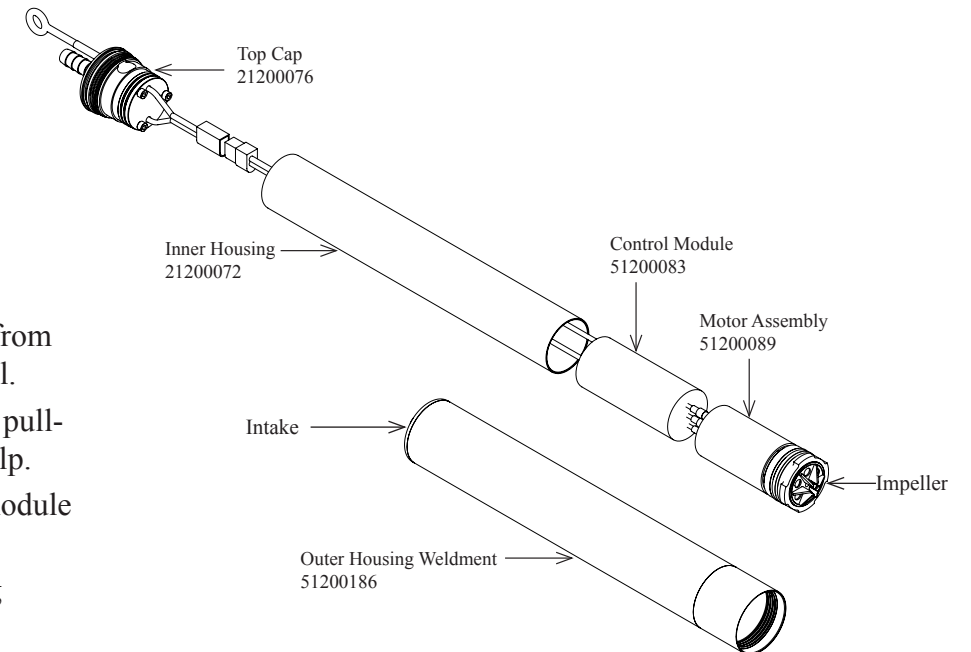

PARTS

PART

1. SS GEOSUB CONTROLLER 300 W 120 V	81200031
2. SS GEOSUB CONTROLLER 300 W 230 V	81200032
3. FUSE.....	11200746
4. MANUAL.....	11200813
5. GOLD CONNECTORS & HEAT SHRINK.....	11200754
6. O-RING KIT.....	51200088
7. CHECK VALVE (OPTION).....	81200033